

APPENDIX A
DETAILED DESIGN DRAWINGS

NEWCASTLE COAL INFRASTRUCTURE GROUP

NEWCASTLE COAL EXPORT TERMINAL

RAIL

STAGE 2F - FLYOVER

APRIL 2012

DRAWING INDEX

ITEM No.	DRG NO	REVISION	TITLE
1	HW03-01-R-82001	A6	COVER SHEET AND DRAWING LIST

KOORAGANG BRANCH LINE TEMPORARY DEVIATION

STAGE 2F:

2	HW03-01-R-82002	A3	GENERAL ARRANGEMENT
3	HW03-01-R-82003	A3	TYPICAL FORMATION - CROSS SECTION
4	HW03-01-R-82004	A4	KOORAGANG BRANCH LINE - TEMPORARY DEVIATION - SETOUT PLAN - SHEET 1 OF 2
5	HW03-01-R-82005	A4	KOORAGANG BRANCH LINE - TEMPORARY DEVIATION - SETOUT PLAN - SHEET 2 OF 2
6	HW03-01-R-82006	A4	UP KOORAGANG BRANCH LINE - TEMPORARY DEVIATION - LONGITUDINAL SECTION
7	HW03-01-R-82007	A3	DOWN KOORAGANG BRANCH LINE - TEMPORARY DEVIATION - LONGITUDINAL SECTION

FINAL LAYOUT

STAGE 2F:

8	HW03-01-R-82008	A4	KOORAGANG UP/DOWN BRANCH LINES - GENERAL ARRANGEMENT
9	HW03-01-R-82009	A4	NCIG ARRIVAL ROADS - GENERAL ARRANGEMENT
10	HW03-01-R-82010	A3	TURNOUTS - GEOMETRY SCHEMATICS
11	HW03-01-R-82011	A2	TYPICAL FORMATION - CROSS SECTION - SHEET 1 OF 2
12	HW03-01-R-82012	A2	TYPICAL FORMATION - CROSS SECTION - SHEET 2 OF 2
13	HW03-01-R-82013	A3	TRAIN STORAGE SCHEMATIC PLAN
14	HW03-01-R-82014	A3	TRAIN STORAGE SCHEMATIC PLAN - FOR 1500m LONG TRAINS
15	HW03-01-R-82015	A3	TRAIN STORAGE SCHEMATIC PLAN - FOR 1700m LONG TRAINS
16	HW03-01-R-82016	A4	KOORAGANG BRANCH LINE - SETOUT PLAN - SHEET 1 OF 3
17	HW03-01-R-82017	A5	KOORAGANG BRANCH LINE - SETOUT PLAN - SHEET 2 OF 3
18	HW03-01-R-82018	A5	KOORAGANG BRANCH LINE - SETOUT PLAN - SHEET 3 OF 3
19	HW03-01-R-82019	A5	UP KOORAGANG BRANCH LINE - LONGITUDINAL SECTION - SHEET 1 OF 2
20	HW03-01-R-82020	A5	UP KOORAGANG BRANCH LINE - LONGITUDINAL SECTION - SHEET 2 OF 2
21	HW03-01-R-82021	A4	DOWN KOORAGANG BRANCH LINE - LONGITUDINAL SECTION - SHEET 1 OF 2
22	HW03-01-R-82022	A5	DOWN KOORAGANG BRANCH LINE - LONGITUDINAL SECTION - SHEET 2 OF 2
23	HW03-01-R-82023	A5	NCIG ARRIVAL ROADS - SETOUT PLAN - SHEET 1 OF 7
24	HW03-01-R-82024	A5	NCIG ARRIVAL ROADS - SETOUT PLAN - SHEET 2 OF 7
25	HW03-01-R-82025	A5	NCIG ARRIVAL ROADS - SETOUT PLAN - SHEET 3 OF 7
26	HW03-01-R-82026	A3	NCIG ARRIVAL ROADS - SETOUT PLAN - SHEET 4 OF 7
27	HW03-01-R-82027	A5	NCIG ARRIVAL ROADS - SETOUT PLAN - SHEET 5 OF 7
28	HW03-01-R-82028	A4	NCIG ARRIVAL ROADS - SETOUT PLAN - SHEET 6 OF 7
29	HW03-01-R-82029	A4	NCIG ARRIVAL ROADS - SETOUT PLAN - SHEET 7 OF 7
30	HW03-01-R-82030	A3	NCIG ARRIVAL ROAD No.1 - LONGITUDINAL SECTION - SHEET 1 OF 3
31	HW03-01-R-82031	A2	NCIG ARRIVAL ROAD No.1 - LONGITUDINAL SECTION - SHEET 2 OF 3
32	HW03-01-R-82032	A2	NCIG ARRIVAL ROAD No.1 - LONGITUDINAL SECTION - SHEET 3 OF 3
33	HW03-01-R-82033	A3	NCIG ARRIVAL ROAD No.2 - LONGITUDINAL SECTION - SHEET 1 OF 3
34	HW03-01-R-82034	A2	NCIG ARRIVAL ROAD No.2 - LONGITUDINAL SECTION - SHEET 2 OF 3
35	HW03-01-R-82035	A2	NCIG ARRIVAL ROAD No.2 - LONGITUDINAL SECTION - SHEET 3 OF 3
36	HW03-01-R-82036	A4	NCIG ARRIVAL ROAD No.3 - LONGITUDINAL SECTION - SHEET 1 OF 3
37	HW03-01-R-82037	A2	NCIG ARRIVAL ROAD No.3 - LONGITUDINAL SECTION - SHEET 2 OF 3
38	HW03-01-R-82038	A2	NCIG ARRIVAL ROAD No.3 - LONGITUDINAL SECTION - SHEET 3 OF 3
39	HW03-01-R-82039	A4	NCIG DEPARTURE ROAD No.1 - LONGITUDINAL SECTION
40	HW03-01-R-82040	A3	NCIG DEPARTURE ROAD No.2 - LONGITUDINAL SECTION
41	HW03-01-R-82041	A4	NCIG DEPARTURE ROAD No.3 - LONGITUDINAL SECTION - SHEET 1 OF 2
42	HW03-01-R-82042	A4	NCIG DEPARTURE ROAD No.3 - LONGITUDINAL SECTION - SHEET 2 OF 2
43	HW03-01-R-82043	A4	NCIG ARRIVAL ROADS CROSSOVERS - LONGITUDINAL SECTIONS
44	HW03-01-R-82044	A3	NCIG DEPARTURE ROADS CROSSOVERS & CRIPPLE SIDING No.2 - LONGITUDINAL SECTIONS

LOCALITY PLAN



Rev	Date	Revision Details	Drn	Ver	App
A6	30/04/12	DRAWING REVISIONS UPDATED		NS	
A5	17/01/12	VERIFICATION COMPLETE		NS	
A4	17/11/11	DRAWING REVISIONS UPDATED		NS	
A3	10/10/11	DRAWING REVISIONS UPDATED		NS	
A2	06/10/11	DRAWING REVISIONS UPDATED		NS	
A1	06/09/11	PRELIMINARY ISSUE		NS	

aurecon HATCH

Aurecon Hatch ABN 21 646 421 651 Telephone: +61 2 9465 5590
 116 Military Road (PO Box 538) Neutral Bay Facsimile: +61 2 9465 5598
 New South Wales 2089 Australia Email: NCIGStage2F@aureconhatch.com

A person using Aurecon Hatch drawings and other data accepts the risk of:
 1. Using the drawings and other data in situations for which they are not intended.
 2. Using the drawings or other data for any purpose not agreed to in writing by Aurecon Hatch.

Client:

Newcastle Coal
 INFRASTRUCTURE GROUP

Drawn	Signed	Date
NS	Signed	
Designed	Signed	Date
NS	Signed	
Verified	Signed	Date
SM	Signed	
Approved	Signed	Date
DIB	Signed	

NCIG COAL EXPORT TERMINAL - STAGE 2F
 RAIL AREA
 COVER SHEET AND DRAWING LIST

PRELIMINARY NOT FOR CONSTRUCTION	
Project No.	H337400
Scale	NTS
Sheet Size	A1
Drawing No.	HW03-01-R-82001
Rev.	A6

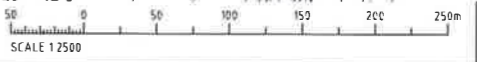

PRELIMINARY
NOT FOR CONSTRUCTION

Rev	Date	Revision Details	Drn	Ver	App
A4	23/05/12	CLIENT AMENDMENTS			AR
A3	17/01/12	VERIFICATION COMPLETE			NS
A2	05/10/11	DRAWING TITLE REVISED			NS
A1	05/09/11	PRELIMINARY ISSUE			NS

aurecon HATCH

Aurecon Hatch ABN 21 846 421 651 Telephone: +61 2 9465 5599
 116 Military Road (PO Box 538) Neutral Bay Facsimile: +61 2 9465 5598
 New South Wales 2089 Australia Email: NCIGStage2F@aureconhatch.com

A person using Aurecon Hatch Drawings and other data accepts the risk of:
 1 Using the drawings and other data in electronic form without requesting and checking that the accuracy against the original hard copy version.
 2 Using the drawings or other data for any purpose not agreed to in writing by Aurecon Hatch.

Client

Newcastle Coal
INFRASTRUCTURE GROUP

Drawn	Signed	Date
NS	Signed	Date
Designed	Signed	Date
NS	Signed	Date
Verified	Signed	Date
SM	Signed	Date
Approved	Signed	Date
DIB	Signed	Date

NCIG COAL EXPORT TERMINAL - STAGE 2F
 RAIL AREA
 KOORAGANG BRANCH LINE
 TEMPORARY DEVIATION
 GENERAL ARRANGEMENT

Project No.	H337400
Scale	Sheet Size
	A1
Drawing No.	Rev
HW03-01-R-82002	A4

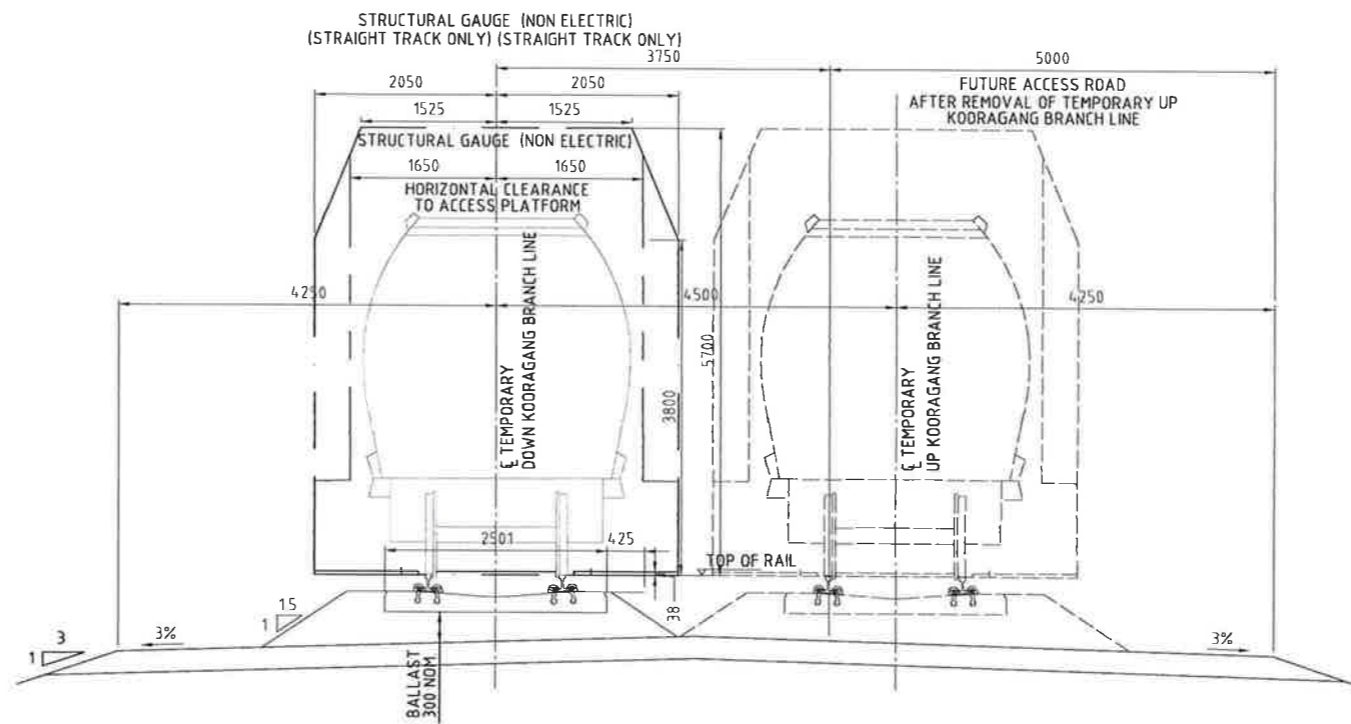

TYPICAL TRACK FORMATION - TEMPORARY KOORAGANG BRANCH LINE
SCALE - 1:40

- NOTES :**
1. TRACKWORK TO BE CLASS 1XC TO ARTC STANDARD TDS11.
 2. ALL PROPOSED TRACKWORK DESIGNED TO ARTC STANDARD TDS10
 3. FORMATION SHOWN INDICATIVE ONLY , REFER TO CIVIL DRAWINGS FOR DETAIL.
 4. ALL DIMENSIONS ARE IN MILLIMETRES UNLESS SHOWN OTHERWISE.
 5. STRUCTURAL VEHICLE ENVELOPE AND WALKWAY POSITION AND DIMENSIONS ARE INDICATIVE ONLY.

Rev	Date	Revision Details	Drn	Ver.	App.
A2	06/10/11	ACCESS ROAD DIMENSION ADDED		NS	
A1	06/09/11	PRELIMINARY ISSUE		NS	

aurecon HATCH

Aurecon Hatch ABN 21 646 421 651 Telephone: +61 2 9465 5599
 116 Military Road (PO Box 538) Neutral Bay Facsimile: +61 2 9465 5598
 New South Wales 2089 Australia Email: NCIGStage2F@aureconhatch.com

A person using Aurecon Hatch drawings and/or data accepts the risk of:
 1. Using the drawings and/or data in circumstances for which they were not intended.
 2. Using the drawings and/or data for any purpose not agreed to in writing by Aurecon Hatch.

Client:

Newcastle Coal
INFRASTRUCTURE GROUP

Drawn	Signed	Date
NS		
Designed	Signed	Date
Verified	Signed	Date
Approved	Signed	Date

NCIG COAL EXPORT TERMINAL - STAGE 2F
RAIL AREA
KOORAGANG BRANCH LINE
TEMPORARY DEVIATION
TYPICAL FORMATION CROSS SECTION

PRELIMINARY NOT FOR CONSTRUCTION	
Project No.	H337400
Scale	NTS
Sheet Size	A1
Drawing No.	HW03-01-R-82003
Rev.	A2

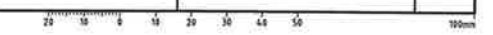

SCHEDULE OF CO-ORDINATED HORIZONTAL ALIGNMENT POINTS UP KOORAGANG BRANCH LINE DEVIATION					
CURVE	POINT	Km	CENTRELINE	CO-ORDINATES	
				EAST	NORTH
250.000 L	START	171 052.332	CL 4ft-UP KOORAGANG BRANCH	367 265.160	1 361 458.967
	TP	171 055.206	CL 4ft-UP KOORAGANG BRANCH	367 266.967	1 361 461.202
	CENTRE			367 072.576	1 361 618.403
250.00 R	TP	171 125.176	CL 4ft-UP KOORAGANG BRANCH	367 302.828	1 361 521.017
	TP	171 155.330	CL 4ft-UP KOORAGANG BRANCH	367 314.575	1 361 548.789
	CENTRE			367 544.827	1 361 451.403
	TP	171 230.154	CL 4ft-UP KOORAGANG BRANCH	367 353.525	1 361 612.349
	TP	171 344.904	CL 4ft-UP KOORAGANG BRANCH	367 427.399	1 361 700.157

SCHEDULE OF CO-ORDINATED HORIZONTAL ALIGNMENT POINTS DOWN KOORAGANG BRANCH LINE DEVIATION					
CURVE	POINT	Km	CENTRELINE	CO-ORDINATES	
				EAST	NORTH
250.000 L	TP	171 051.445	CL 4ft-DOWN KOORAGANG BRANCH	367 261.790	1 361 460.561
	CENTRE			367 067.441	1 361 617.814
	TP	171 121.481	CL 4ft-DOWN KOORAGANG BRANCH	367 297.693	1 361 520.428
254.500 R	TP	171 154.178	CL 4ft-DOWN KOORAGANG BRANCH	367 310.430	1 361 550.542
	CENTRE			367 544.827	1 361 451.403
	TP	171 230.349	CL 4ft-DOWN KOORAGANG BRANCH	367 350.082	1 361 615.246
	TP	171 345.099	CL 4ft-DOWN KOORAGANG BRANCH	367 423.956	1 361 703.054



ADJOINS DRAWING HW03-01-R-82005

CIRCULAR CURVE DETAILS
C/L 4ft DOWN KOORAGANG DEVIATION
RADIUS : 250.000m LEFT
ARC : 70.036m
V : 30 km/hr
Ea : 0mm
D : 42.6mm

CIRCULAR CURVE DETAILS
C/L 4ft NCIG - UP KOORAGANG DEVIATION
RADIUS : 250.000m LEFT
ARC : 69.970m
V : 30 km/hr
Ea : 0mm
D : 42.6mm

CIRCULAR CURVE DETAILS
C/L 4ft DOWN KOORAGANG DEVIATION
RADIUS : 254.500m RIGHT
ARC : 76.171m
V : 30 km/hr
Ea : 0mm
D : 41.8mm

CIRCULAR CURVE DETAILS
C/L 4ft UP KOORAGANG DEVIATION
RADIUS : 250.000m RIGHT
ARC : 74.825m
V : 30 km/hr
Ea : 0mm
D : 42.6mm

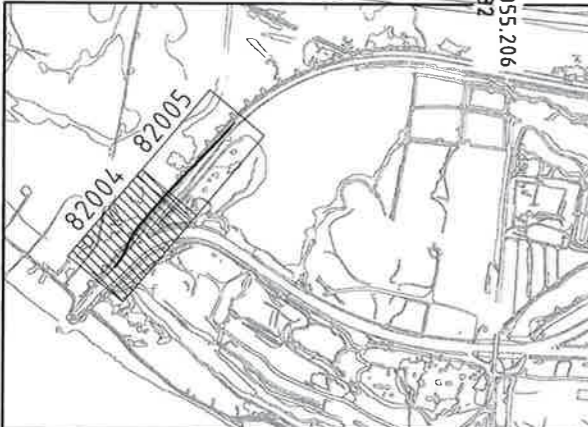
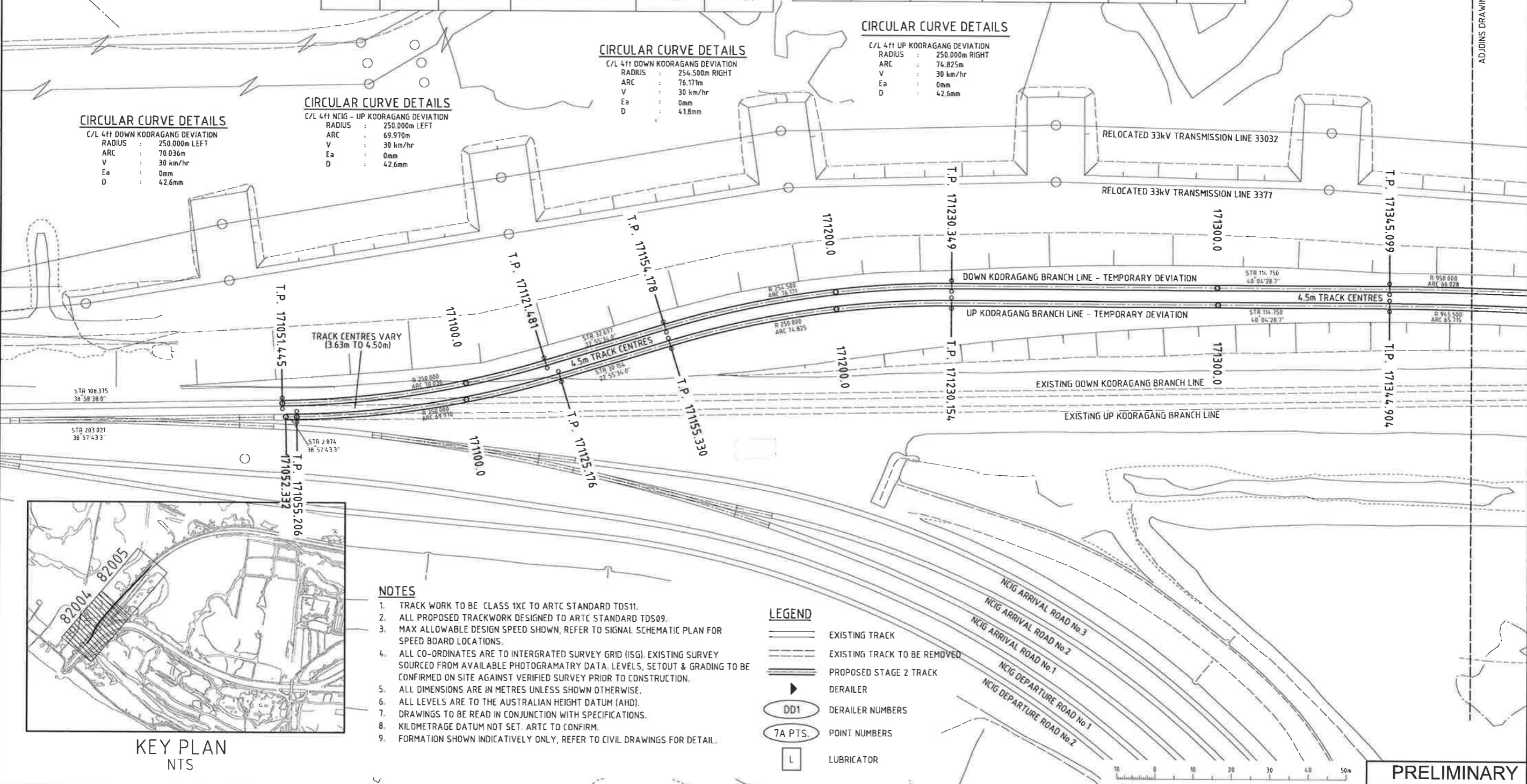

- NOTES**
1. TRACK WORK TO BE CLASS 1XC TO ARTC STANDARD TDS11.
 2. ALL PROPOSED TRACKWORK DESIGNED TO ARTC STANDARD TDS09.
 3. MAX ALLOWABLE DESIGN SPEED SHOWN, REFER TO SIGNAL SCHEMATIC PLAN FOR SPEED BOARD LOCATIONS.
 4. ALL CO-ORDINATES ARE TO INTERGRATED SURVEY GRID (ISG). EXISTING SURVEY SOURCED FROM AVAILABLE PHOTOGRAMATRY DATA. LEVELS, SETOUT & GRADING TO BE CONFIRMED ON SITE AGAINST VERIFIED SURVEY PRIOR TO CONSTRUCTION.
 5. ALL DIMENSIONS ARE IN METRES UNLESS SHOWN OTHERWISE.
 6. ALL LEVELS ARE TO THE AUSTRALIAN HEIGHT DATUM (AHD).
 7. DRAWINGS TO BE READ IN CONJUNCTION WITH SPECIFICATIONS.
 8. KILOMETRAGE DATUM NOT SET. ARTC TO CONFIRM.
 9. FORMATION SHOWN INDICATIVELY ONLY, REFER TO CIVIL DRAWINGS FOR DETAIL.

- LEGEND**
- EXISTING TRACK
 - EXISTING TRACK TO BE REMOVED
 - PROPOSED STAGE 2 TRACK
 - DERAILER
 - DD1 DERAILER NUMBERS
 - 7A PTS. POINT NUMBERS
 - L LUBRICATOR

Rev.	Date	Revision Details	Drn	Ver.	App.
A4	17/01/12	VERIFICATION COMPLETE		NS	
A3	17/11/11	DRAFTING REVIEW COMMENTS INCORPORATED		NS	
A2	06/10/11	CONNECTION TO MAINLINE FINALISED		NS	
A1	06/09/11	PRELIMINARY ISSUE		NS	

aurecon HATCH

Aurecon Hatch ABN 21 646 421 651 Telephone: +61 2 9465 5599
 116 Military Road (PO Box 538) Neutral Bay Facsimile: +61 2 9465 5598
 New South Wales 2089 Australia Email: NCIGStage2F@aureconhatch.com

A person using Aurecon Hatch drawings and other data accepts the responsibility for any errors and omissions and shall indemnify and hold Aurecon Hatch harmless from any claims, damages, costs and expenses, including legal costs, arising from the use of the drawings and other data.

Client:

Newcastle Coal
INFRASTRUCTURE GROUP

Drawn	Signed	Date
NS		
Designed	Signed	Date
NS		
Verified	Signed	Date
SM		
Approved	Signed	Date
DIB		

NCIG COAL EXPORT TERMINAL - STAGE 2F
RAIL AREA
KOORAGANG BRANCH LINE
TEMPORARY DEVIATION
SETOUT PLAN - SHEET 1 OF 2

PRELIMINARY
NOT FOR CONSTRUCTION

Project No. H337400

Scale 1:500 Sheet Size A1

Drawing No. HW03-01-R-82004 Rev. A4



SCHEDULE OF CO-ORDINATED HORIZONTAL ALIGNMENT POINTS UP KOORAGANG BRANCH LINE DEVIATION					
CURVE	POINT	Km	CENTRELINE	CO-ORDINATES	
				EAST	NORTH
945.500 R	CENTRE	171 410.619	CL 4ft-UP KOORAGANG BRANCH	368 150.902	1 361 091.458
	TP	171 637.592	CL 4ft-UP KOORAGANG BRANCH	367 471.418	1 361 748.932
1000.000 L	CENTRE	171 647.557	CL 4ft-UP KOORAGANG BRANCH	366 910.599	1 362 607.418
	T.P. (END)	171 695.650	CL 4ft-UP KOORAGANG BRANCH	367 636.142	1 361 919.242
807.076 R	CENTRE		CL 4ft-UP KOORAGANG BRANCH	367 669.239	1 361 954.135
				368 254.807	1 361 398.724

SCHEDULE OF CO-ORDINATED HORIZONTAL ALIGNMENT POINTS DOWN KOORAGANG BRANCH LINE DEVIATION					
CURVE	POINT	Km	CENTRELINE	CO-ORDINATES	
				EAST	NORTH
950.000 R	CENTRE	171 411.127	CL 4ft-DOWN KOORAGANG BRANCH	368 150.902	1 361 091.458
	TP	171 685.879	CL 4ft-DOWN KOORAGANG BRANCH	367 468.185	1 361 752.061
818.330 R	TRS (END)	171 720.879	CL 4ft-DOWN KOORAGANG BRANCH	367 659.240	1 361 949.512
	CENTRE			367 683.756	1 361 974.490
				368 259.540	1 361 392.995

CIRCULAR CURVE DETAILS

C/L 4ft DOWN KOORAGANG DEVIATION
 RADIUS : 950.000m RIGHT
 ARC : 66.028m
 V : 30 km/hr
 Ea : 0mm
 D : 112mm

CIRCULAR CURVE DETAILS

C/L 4ft UP KOORAGANG DEVIATION
 RADIUS : 945.500m RIGHT
 ARC : 65.715m
 V : 30 km/hr
 Ea : 0mm
 D : 113mm

TRANSITION DETAILS

C/L 4ft DOWN KOORAGANG DEVIATION
 RADIUS : 818.330m RIGHT
 L : 35.000
 Xc : 34.998
 m : 5.822174E-06
 RAMP : 1 in 1400
 Droc : -2.9mm/sec

EXISTING CIRCULAR CURVE DETAILS

(DETERMINED FROM FIELD SURVEY)
 C/L 4ft DOWN KOORAGANG
 RADIUS : 818.330m RIGHT
 ARC : 35.000
 V : 30 km/hr
 Ea : 25mm
 D : -12.0mm

CIRCULAR CURVE DETAILS

C/L 4ft UP KOORAGANG DEVIATION
 RADIUS : 1000.000m LEFT
 ARC : 9.965m
 V : 30 km/hr
 Ea : 0mm
 D : 10.6mm

EXISTING CIRCULAR CURVE DETAILS

(DETERMINED FROM FIELD SURVEY)
 C/L 4ft UP KOORAGANG
 RADIUS : 807.076m RIGHT
 ARC : 35.000
 V : 30 km/hr
 Ea : 0mm
 D : 13.2mm

NOTES

1. FOR GENERAL RAIL NOTES REFER TO DRG HW03-01-R-82004

LEGEND

- EXISTING TRACK
- EXISTING TRACK TO BE REMOVED
- PROPOSED STAGE 2 TRACK
- DERAILER
- DERAILER NUMBERS
- POINT NUMBERS
- LUBRICATOR



PRELIMINARY
NOT FOR CONSTRUCTION

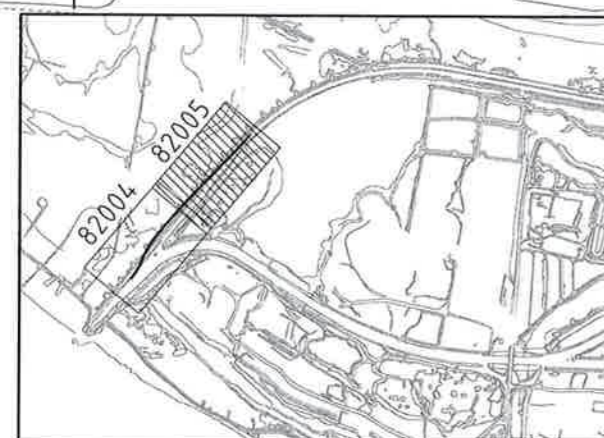
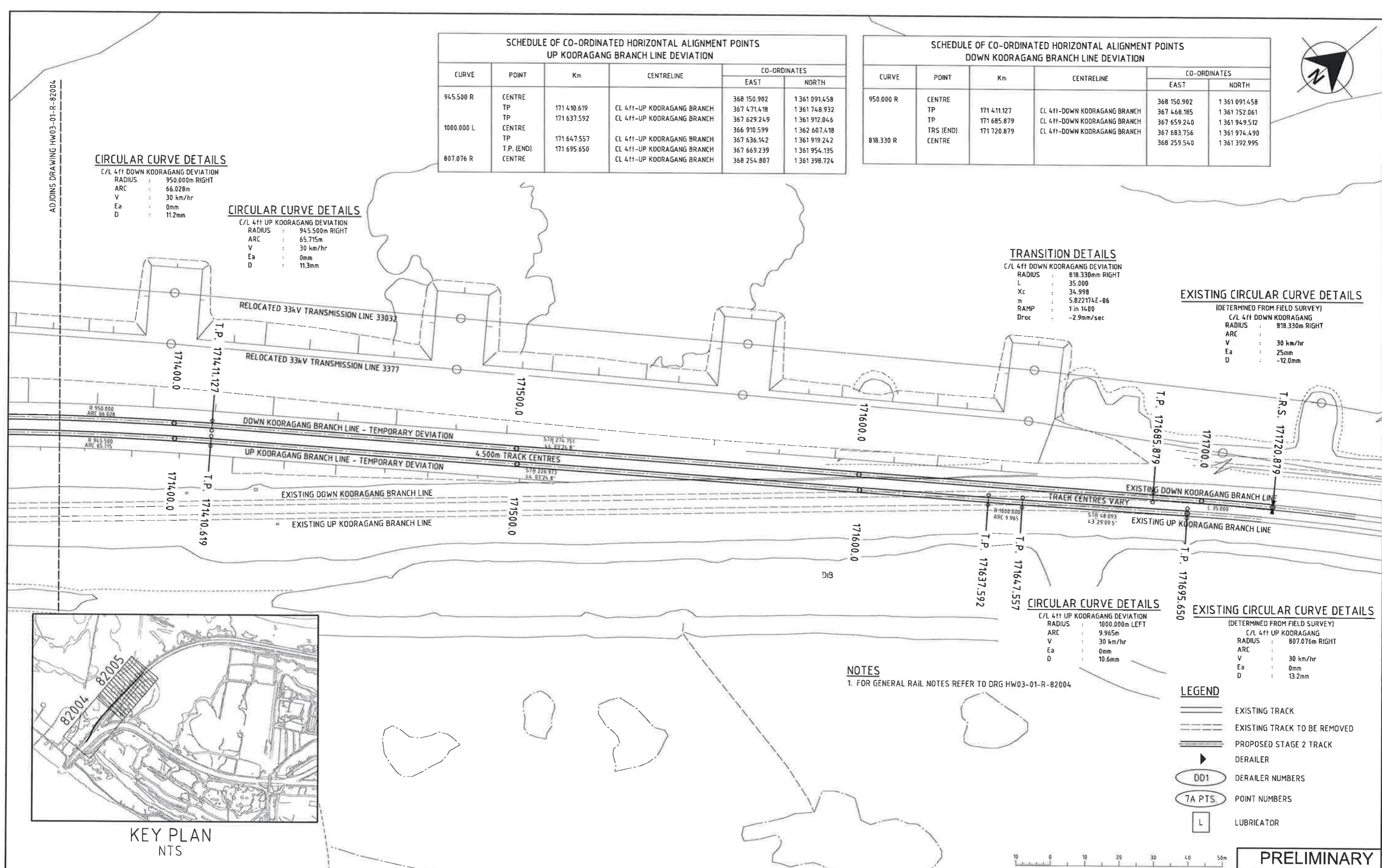

KEY PLAN
NTS

Rev	Date	Revision Details	Drn	Ver.	App.
A4	17/01/12	VERIFICATION COMPLETE		NS	
A3	17/11/11	DRAFTING REVIEW COMMENTS INCORPORATED		NS	
A2	06/10/11	CONNECTION TO MAINLINE FINALISED		NS	
A1	06/09/11	PRELIMINARY ISSUE		NS	

aurecon HATCH
 Aurecon Hatch ABN 21 646 421 651 Telephone: +61 2 9465 5599
 116 Military Road (PO Box 538) Neutral Bay Facsimile: +61 2 9465 5598
 New South Wales 2088 Australia Email: NCIGStage2F@aureconhatch.com

Newcastle Coal
 INFRASTRUCTURE GROUP

Drawn	Signed	Date
NS		
Designed	Signed	Date
NS		
Verified	Signed	Date
SM		
Approved	Signed	Date
DIB		

NCIG COAL EXPORT TERMINAL - STAGE 2F
RAIL AREA
KOORAGANG BRANCH LINE
TEMPORARY DEVIATION
SETOUT PLAN - SHEET 2 OF 2

Project No.	H337400
Scale	1:500
Drawing No.	HW03-01-R-82005
Sheet Size	A1
Rev.	A4

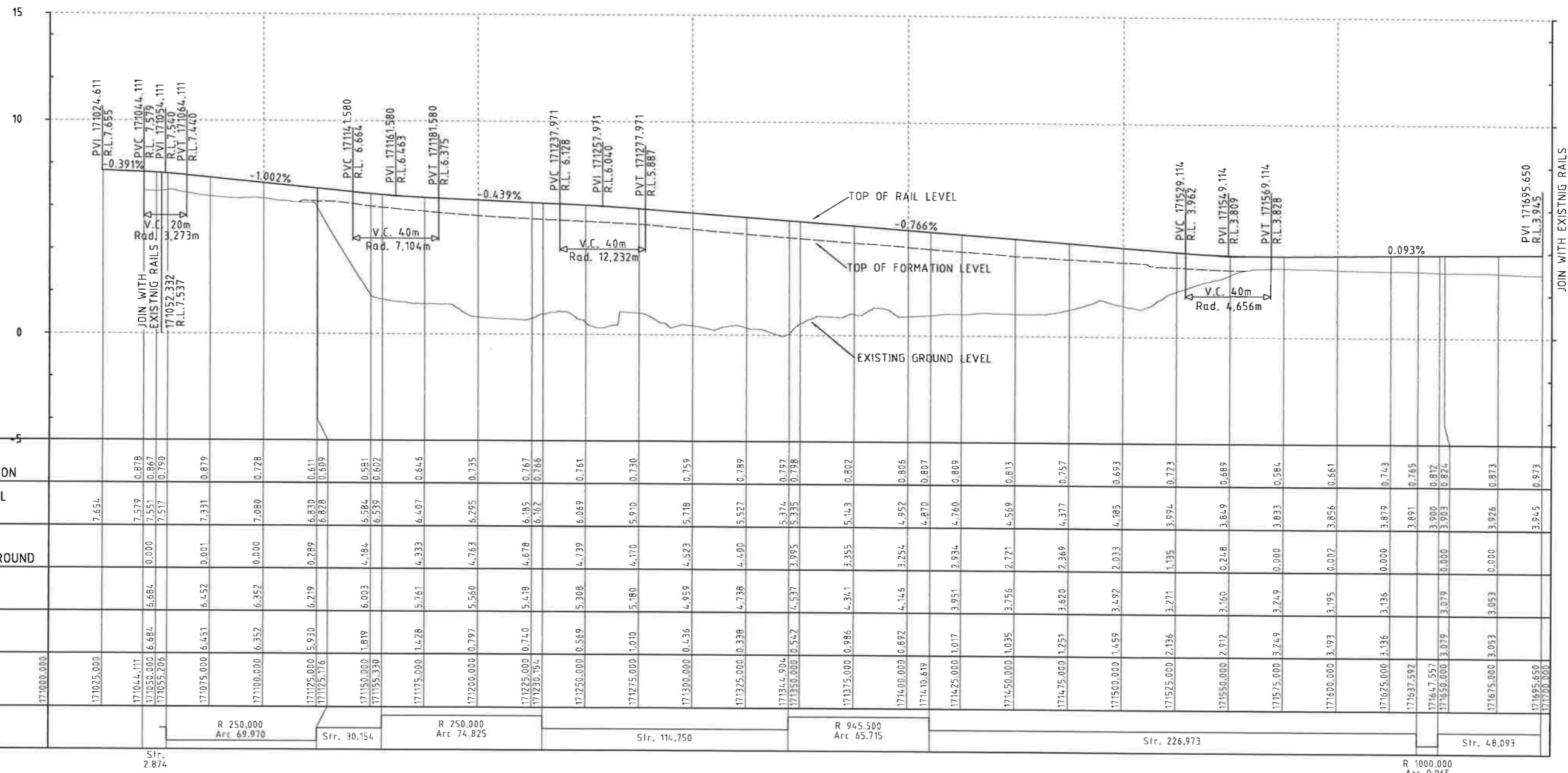

LONGITUDINAL SECTION
UP KOORAGANG BRANCH LINE
CHAINAGE 171.052332km TO 171.700km

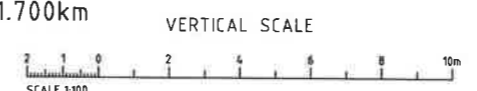
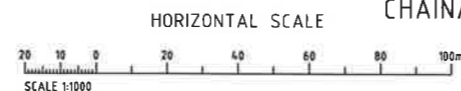

- NOTES**
1. ALL TRACK WORK TO BE BUILT TO CLASS 1XC TO ARTC STANDARD TSD11.
 2. ALL PROPOSED TRACKWORK DESIGNED TO ARTC STANDARD TDS10.
 3. EXISTING SURVEY SOURCED FROM AVAILABLE PHOTOGRAMATRY DATA. SETOUT & GRADING TO BE CONFIRMED ON SITE AGAINST VERIFIED SURVEY.
 4. ALL DIMENSIONS ARE IN METRES UNLESS SHOWN OTHERWISE.
 5. ALL LEVELS ARE TO THE AUSTRALIAN HEIGHT DATUM (AHD).
 6. ALL LEVELS ARE MEASURED IN METRES UNLESS SHOWN OTHERWISE.

Rev.	Date	Revision Details	Drn	Ver.	App.
A4	17/01/12	VERIFICATION COMPLETE	NS		
A3	17/11/11	DRAFTING REVIEW COMMENTS INCORPORATED	NS		
A2	06/10/11	GRADING CONNECTION TO MAILINE FINALISED	NS		
A1	06/09/11	PRELIMINARY ISSUE	NS		

aurecon HATCH

Aurecon Hatch ABN 21 646 421 651 Telephone: +61 2 9465 5599
116 Military Road (PO Box 538) Neutral Bay Facsimile: +61 2 9465 5598
New South Wales 2089 Australia Email: NCIGStage2F@aureconhatch.com

Client:

Newcastle Coal
INFRASTRUCTURE GROUP

Drawn	Signed	Date
NS	Signed	
Designed	Signed	Date
NS	Signed	
Verified	Signed	Date
SM	Signed	
Approved	Signed	Date
DIB	Signed	

NCIG COAL EXPORT TERMINAL - STAGE 2F
RAIL AREA
UP KOORAGANG BRANCH LINE
TEMPORARY DEVIATION
LONGITUDINAL SECTION

PRELIMINARY
NOT FOR CONSTRUCTION

Project No. H337400

Scale: 1:100
1:1000

Drawing No. HW03-01-R-82006

Sheet Size: A1
Rev: A4

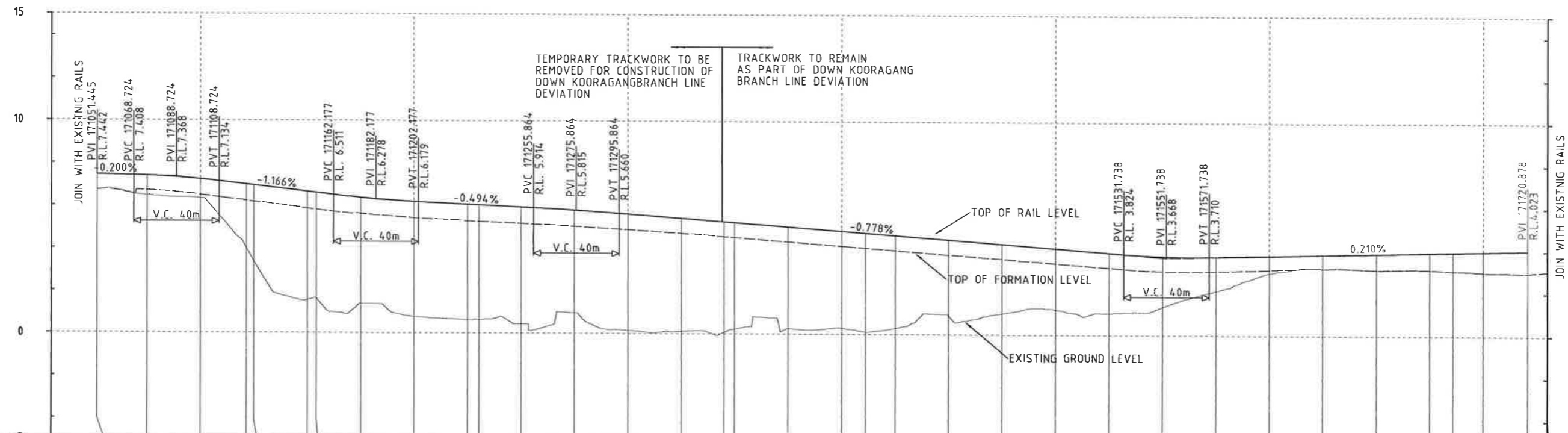

CHAINAGE	EXISTING LEVELS	FORMATION LEVELS	CUT/FILL DEPTH TO EXISTING GROUND	TOP OF RAIL LEVELS	CUT/FILL DEPTH TO FORMATION
171030.000					
171050.000	6.443	6.719	7.442	7.442	0.773
171051.445					
171075.000	6.469	6.695	0.226	7.390	0.695
171100.000	6.337	6.492	0.155	7.277	0.735
171121.481					
171125.000	3.372	6.176	2.804	6.986	0.764
171150.000	1.548	5.860	4.312	6.653	0.793
171154.178					
171175.000	1.372	5.620	4.248	6.375	0.755
171200.000	0.771	5.422	4.651	6.190	0.768
171225.000	0.620	5.281	4.661	6.066	0.785
171230.349					
171250.000	0.434	5.172	4.738	5.943	0.771
171275.000	0.967	5.043	4.076	5.806	0.763
171300.000	0.150	4.895	4.745	5.627	0.732
171325.000	0.113	4.726	4.613	5.433	0.707
171345.099					
171350.000	0.236	4.538	4.302	5.276	0.700
171375.000	0.263	4.344	4.081	5.044	0.700
171400.000	0.293	4.149	3.856	4.849	0.700
171411.277					
171425.000	0.395	3.955	3.650	4.763	0.700
171450.000	0.896	3.750	2.864	4.655	0.700
171475.000	1.004	3.566	2.562	4.460	0.700
171500.000	1.180	3.371	2.191	4.266	0.700
171525.000	1.034	3.176	2.142	4.071	0.700
171550.000	1.339	3.027	1.688	3.876	0.700
171575.000	2.097	3.032	0.935	3.723	0.696
171600.000	2.947	3.100	0.153	3.717	0.585
171625.000	3.166	3.166	0.000	3.822	0.656
171650.000	3.118	3.118	0.000	3.874	0.756
171675.000	3.121	3.121	0.000	3.927	0.806
171685.879					
171700.000	3.009	3.009	0.000	3.950	0.884
171720.879					
171730.000					

LONGITUDINAL SECTION
DOWN KOORAGANG BRANCH LINE
CHAINAGE 171.030km TO 171.730km

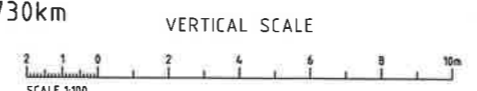
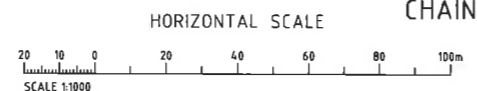

- NOTES**
1. ALL TRACK WORK TO BE BUILT TO CLASS 1XC TO ARTC STANDARD TSD11.
 2. ALL PROPOSED TRACKWORK DESIGNED TO ARTC STANDARD TDS10.
 3. EXISTING SURVEY SOURCED FROM AVAILABLE PHOTOGRAMATRY DATA. SETOUT & GRADING TO BE CONFIRMED ON SITE AGAINST VERIFIED SURVEY.
 4. ALL DIMENSIONS ARE IN METRES UNLESS SHOWN OTHERWISE.
 5. ALL LEVELS ARE TO THE AUSTRALIAN HEIGHT DATUM (AHD).
 6. ALL LEVELS ARE MEASURED IN METRES UNLESS SHOWN OTHERWISE.

Rev.	Date	Revision Details	Drn	Ver	App.
A2	06/10/11	GRADING CONNECTION TO MAINLINE FINALISED	NS		
A1	06/09/11	PRELIMINARY ISSUE	NS		



Drawn	Signed	Date
NS		
Designed	Signed	Date
Verified	Signed	Date
Approved	Signed	Date

NCIG COAL EXPORT TERMINAL - STAGE 2F
RAIL AREA
DOWN KOORAGANG BRANCH LINE
TEMPORARY DEVIATION
LONGITUDINAL SECTION

PRELIMINARY
NOT FOR CONSTRUCTION

Project No. H337400

Scale 1:100
1:1000

Drawing No. HW03-01-R-82007

Sheet Size A1
Rev. A2



SCALE 1:2500

PRELIMINARY
NOT FOR CONSTRUCTION

Rev	Date	Revision Details	Drn	Ver	App
A5	23/05/12	CLIENT AMENDMENTS	AR		
A4	26/04/12	UP KOORAGANG BRANCH LINE ALIGNMENT REVISED	NS		
A3	17/01/12	VERIFICATION COMPLETE	NS		
A2	06/10/11	BACKGROUND EARTHWORKS MODEL REVISED	NS		
A1	06/09/11	PRELIMINARY ISSUE	NS		

aurecon HATCH

Aurecon Hatch ABN 21 648 421 651 Telephone: +61 2 9465 5598
 116 Military Road (PO Box 538) Neutral Bay Facsimile: +61 2 9465 5598
 New South Wales 2089 Australia Email: NCIGStage2F@aureconhatch.com

A 24-hour long Aurecon Hatch or other data accepts the risk of using the drawings and other data in professional form without requiring and checking them for accuracy against the original data. The drawings or other data for any purpose not agreed to in writing by Aurecon Hatch.

Client

Newcastle Coal
INFRASTRUCTURE GROUP

Drawn	Signed	Date
NS		
Designed	Signed	Date
NS		
Verified	Signed	Date
SM		
Approved	Signed	Date
DIB		

NCIG COAL EXPORT TERMINAL - STAGE 2F
RAIL AREA
KOORAGANG UP/DOWN BRANCH LINES
GENERAL ARRANGEMENT

Project No.		H337400	
Scale	Sheet Size		
1:2500	A1		
Drawing No.	Rev.		
HW03-01-R-82008	A5		

20 30 40 50



SCALE 1:3000

PRELIMINARY
NOT FOR CONSTRUCTION

Rev	Date	Revision Details	Drn	Ver	App
A5	23/05/12	CLIENT AMENDMENTS	AR		
A4	26/04/12	JP KOORAGANG BRANCH LINE ALIGNMENT REVISED	NS		
A3	17/01/12	VERIFICATION COMPLETE	NS		
A2	06/10/11	BACKGROUND EARTHWORKS MODEL REVISED	NS		
A1	06/09/11	PRELIMINARY ISSUE	NS		

aurecon HATCH

Aurecon Hatch ABN 21 646 421 651 Telephone: +61 2 9465 5599
 116 Military Road (PO Box 538) Neutral Bay Facsimile: +61 2 9465 5598
 New South Wales 2089 Australia Email: NCIGStage2F@aureconhatch.com

A person using Aurecon Hatch drawings and other data accepts the risk of liability for the drawings and other data in connection with their use and checks them for accuracy against the original hard copy documents. A person using the drawings or other data for any purpose not agreed to in writing by Aurecon Hatch.

Client



Newcastle Coal
INFRASTRUCTURE GROUP

Drawn	Signed	Date
NS		
Designed	Signed	Date
NS		
Verified	Signed	Date
SM		
Approved	Signed	Date
DIB		

NCIG COAL EXPORT TERMINAL - STAGE 2F
RAIL AREA
NCIG ARRIVAL ROADS
GENERAL ARRANGEMENT

Project No.	H337400
Scale	1:3000
Sheet Size	A1
Drawing No.	HW03-01-R-82009
Rev.	A5

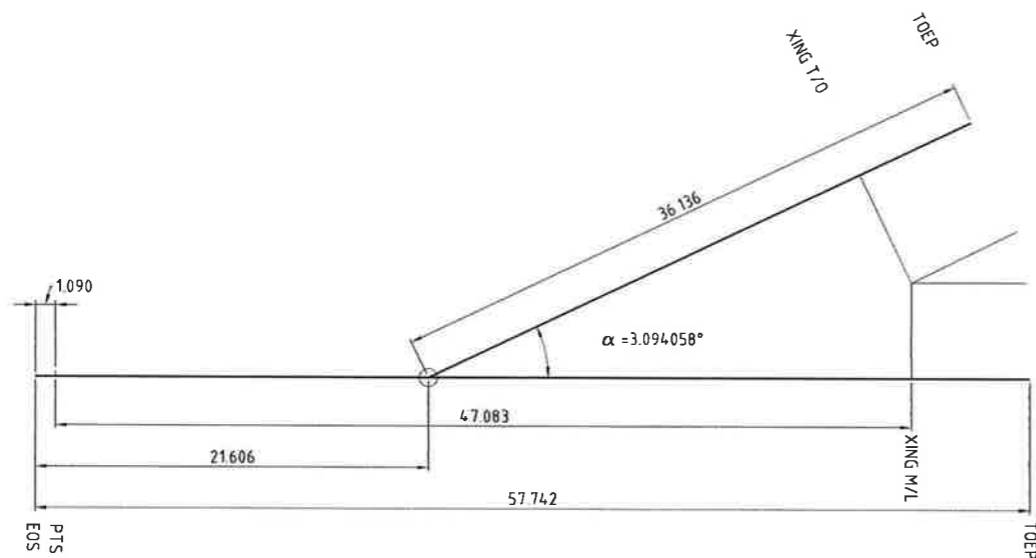

TANGENTIAL TURNOUT - 800:18.5
 REF. DRG PRE01-GA-0305 Rev. 1

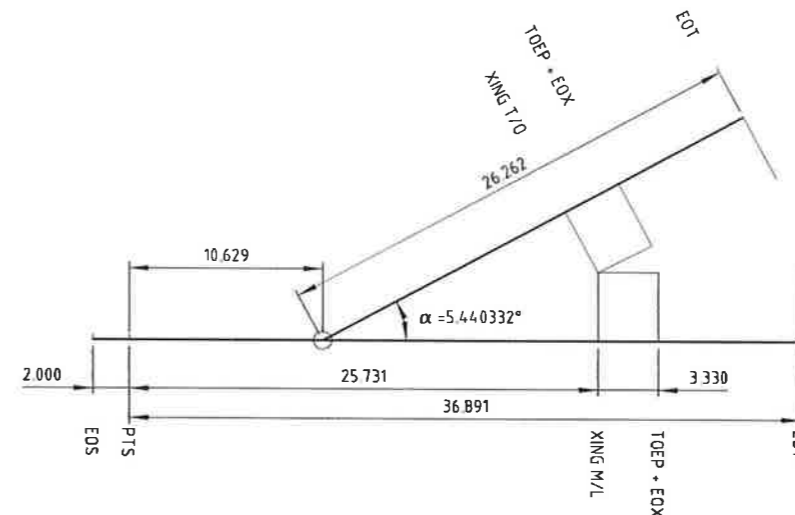

1 IN 10.5 CONVENTIONAL 6100 FLEX TURNOUT
 REF. DRG PRE01-GA-0335 Rev. 2

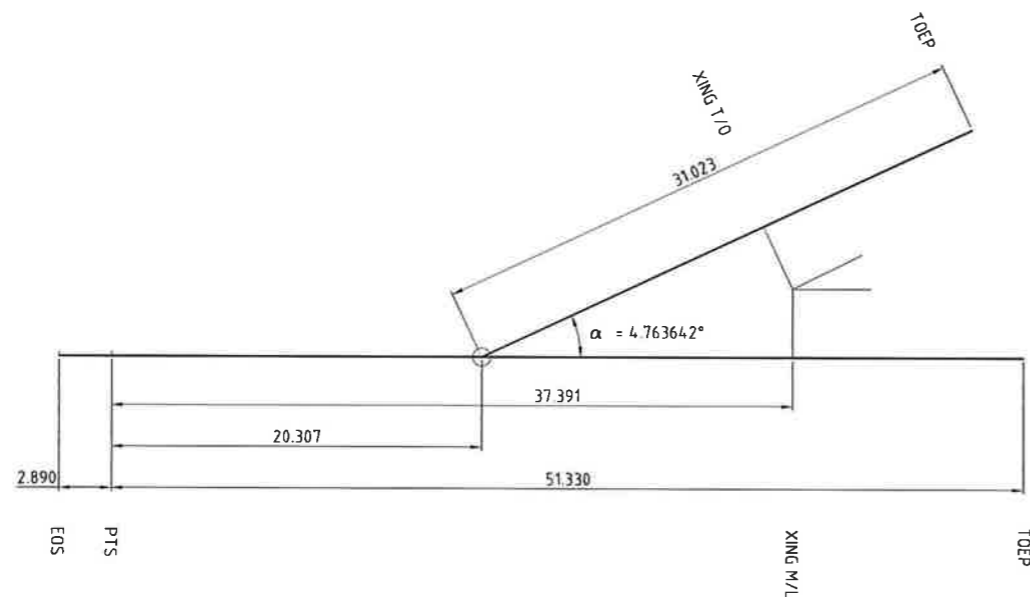

TANGENTIAL TURNOUT 500:12
 (WITH STRAIGHT END INFILL)
 REF. DRG PRE01-GA-0040-01 Rev. 6

NOTES :

1. REFER TO TRACK SETOUT PLANS FOR NOTES & SETOUT CO-ORDINATES.
2. ALL DIMENSIONS ARE IN METRES UNLESS SHOWN OTHERWISE.
3. ANY REFERENCE TO P.R.E. DRAWINGS THAT ARE NON NCIG SPECIFIC, IS FOR THE PURPOSE OF TURNOUT GEOMETRY ONLY
4. ALL NCIG TURNOUTS ARE TO HAVE SIEMENS IN BEARER MOTORS

Rev	Date	Revision Details	Drn	Ver	App
A2	17/11/11	DRAFTING REVIEW COMMENTS INCORPORATED		NS	
A1	06/09/11	PRELIMINARY ISSUE		NS	

aurecon HATCH

Aurecon Hatch ABN 21 846 421 851 Telephone: +61 2 9465 6599
 116 Military Road (PO Box 538) Neutral Bay Facsimile: +61 2 9465 6598
 New South Wales 2089 Australia Email: NCIGSlageZF@aureconhatch.com

A person using Aurecon Hatch drawings and other data accepts the risk of:
 1. Using the drawings and other data in electronic form without requesting and checking them for accuracy against the original hard copy version.
 2. Using the drawings or other data for any purpose not agreed to in writing by Aurecon Hatch.

Client

Newcastle Coal
 INFRASTRUCTURE GROUP

Drawn	Signed	Date
NS		
Designed	Signed	Date
Verified	Signed	Date
Approved	Signed	Date

NCIG COAL EXPORT TERMINAL - STAGE 2F

RAIL AREA
TURNOUTS
GEOMETRY SCHEMATICS

PRELIMINARY NOT FOR CONSTRUCTION	
Project No.	H337400
Scale	NTS
Sheet Size	A1
Drawing No.	HW03-01-R-82010
Rev.	A2

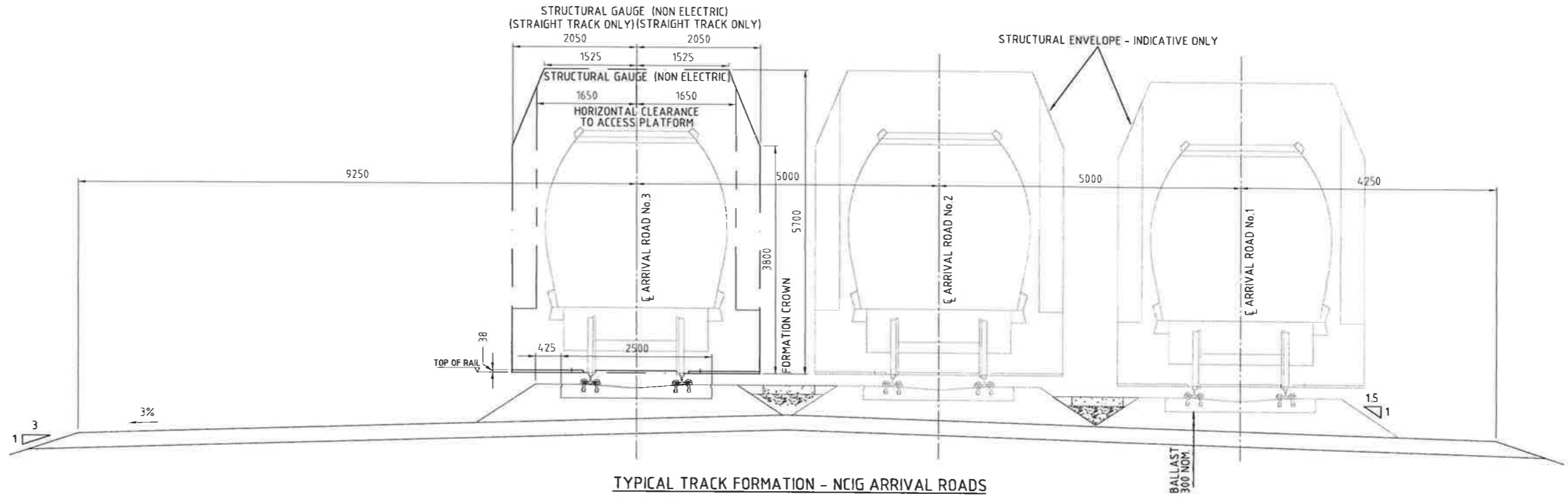

TYPICAL TRACK FORMATION - NCIG ARRIVAL ROADS
SCALE - 1:40

NOTES :

1. TRACKWORK TO BE CLASS 1XC TO ARTC STANDARD TDS11.
2. ALL PROPOSED TRACKWORK DESIGNED TO ARTC STANDARD TDS10
3. FORMATION SHOWN INDICATIVE ONLY, REFER TO CIVIL DRAWINGS FOR DETAIL.
4. ALL DIMENSIONS ARE IN MILLIMETRES UNLESS SHOWN OTHERWISE.
5. STRUCTURAL VEHICLE ENVELOPE AND WALKWAY POSITION AND DIMENSIONS ARE INDICATIVE ONLY.
6. 4.0m TRACK CENTRES (AS PER ARTC STANDARD BDS-12, SECTION 5)
7. STRUCTURAL ENVELOPE AS SHOWN REFERS TO CLEARANCES FROM INFRASTRUCTURE BOTH NEW AND EXISTING. (AS PER ARTC STANDARD BDS 12 SECTION 1)

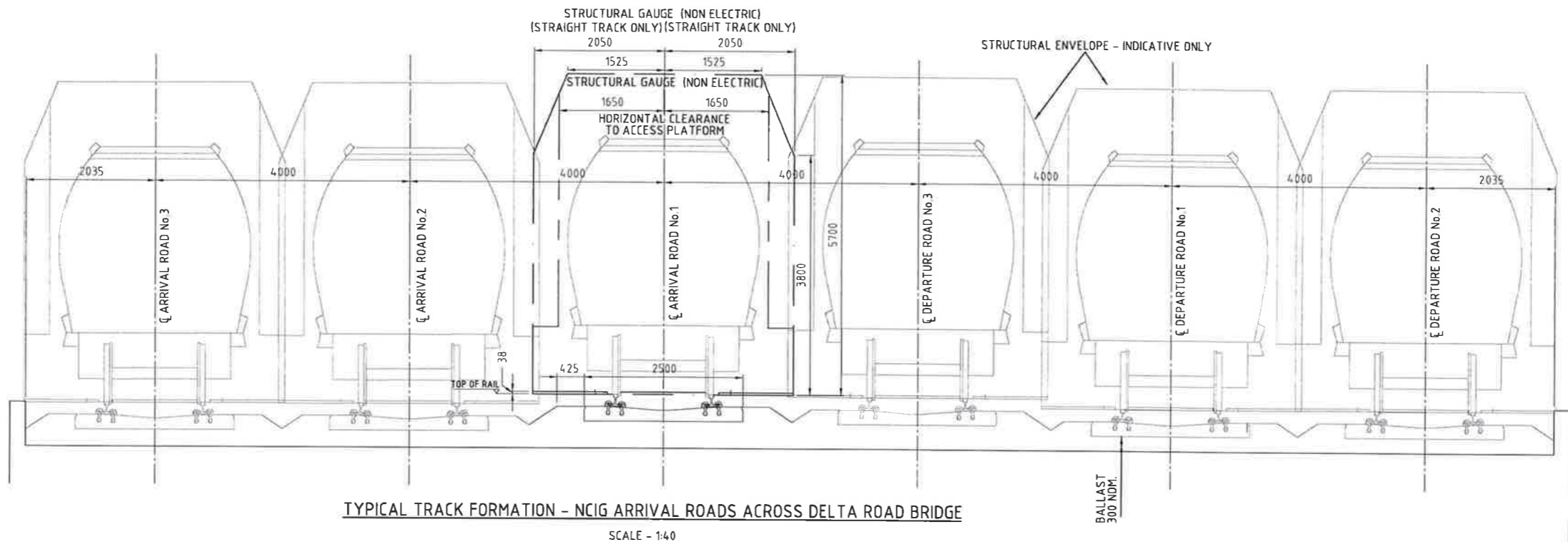

TYPICAL TRACK FORMATION - NCIG ARRIVAL ROADS ACROSS DELTA ROAD BRIDGE
SCALE - 1:40

Rev	Date	Revision Details	Drn	Ver.	App.
A2	17/01/12	VERIFICATION COMPLETE		NS	
A1	06/09/11	PRELIMINARY ISSUE		NS	

aurecon HATCH
 Aurecon Hatch ABN 21 646 421 651 Telephone: +61 2 9465 5589
 116 Military Road (PO Box 538) Neutral Bay Facsimile: +61 2 9465 5588
 New South Wales 2089 Australia Email: NCIGStage2F@aureconhatch.com

Client:

Newcastle Coal
 INFRASTRUCTURE GROUP

Drawn	Signed	Date
NS		
Designed	Signed	Date
NS		
Verified	Signed	Date
SM		
Approved	Signed	Date
DIB		

NCIG COAL EXPORT TERMINAL - STAGE 2F
 RAIL AREA
 TYPICAL FORMATION CROSS SECTION
 SHEET 1 OF 2

PRELIMINARY
 NOT FOR CONSTRUCTION

Project No. H337400
 Scale: NTS Sheet Size: A1
 Drawing No. HW03-01-R-82011 Rev. A2

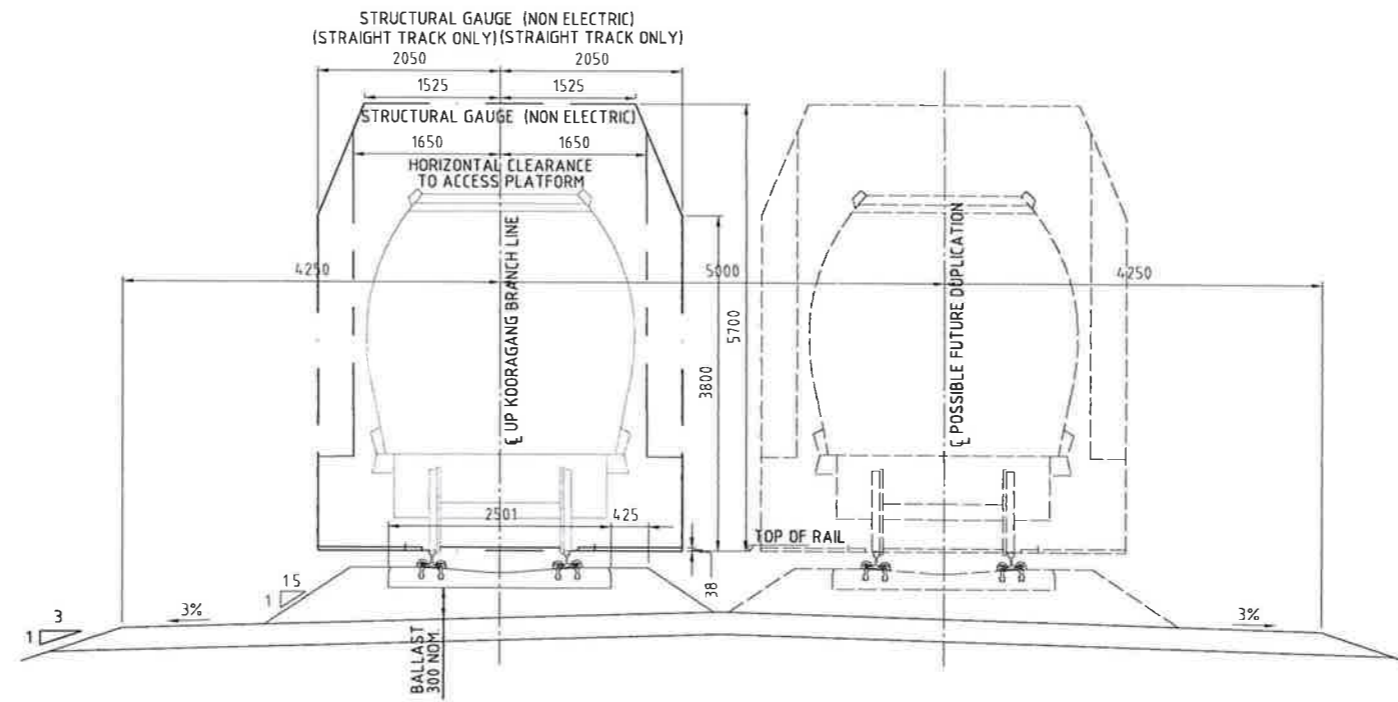

TYPICAL TRACK FORMATION - UP KOORAGANG BRANCH LINE
SCALE - 1:40

NOTES :

1. TRACKWORK TO BE CLASS 1XC TO ARTC STANDARD TDS11.
2. ALL PROPOSED TRACKWORK DESIGNED TO ARTC STANDARD TDS10.
3. FORMATION SHOWN INDICATIVE ONLY , REFER TO CIVIL DRAWINGS FOR DETAIL.
4. ALL DIMENSIONS ARE IN MILLIMETRES UNLESS SHOWN OTHERWISE.
5. STRUCTURAL VEHICLE ENVELOPE AND WALKWAY POSITION AND DIMENSIONS ARE INDICATIVE ONLY.

Rev.	Date	Revision Details	Drn	Ver.	App.
A2	17/01/12	VERIFICATION COMPLETE		NS	
A1	06/09/11	PRELIMINARY ISSUE		NS	

aurecon HATCH
 Aurecon Hatch ABN 21 646 421 651 Telephone: +61 2 9465 5599
 116 Military Road (PO Box 538) Neutral Bay Facsimile: +61 2 9465 5598
 New South Wales 2089 Australia Email: NCIGStage2F@aureconhatch.com

Client:

Newcastle Coal
 INFRASTRUCTURE GROUP

Drawn	Signed	Date
NS		
Designed	Signed	Date
NS		
Verified	Signed	Date
SM		
Approved	Signed	Date
DIB		

NCIG COAL EXPORT TERMINAL - STAGE 2F
 RAIL AREA
 TYPICAL FORMATION CROSS SECTION
 SHEET 2 OF 2

PRELIMINARY NOT FOR CONSTRUCTION	
Project No.	H337400
Scale	NTS
Sheet Size	A1
Drawing No.	HW03-01-R-82012
Rev.	A2

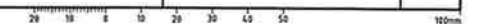

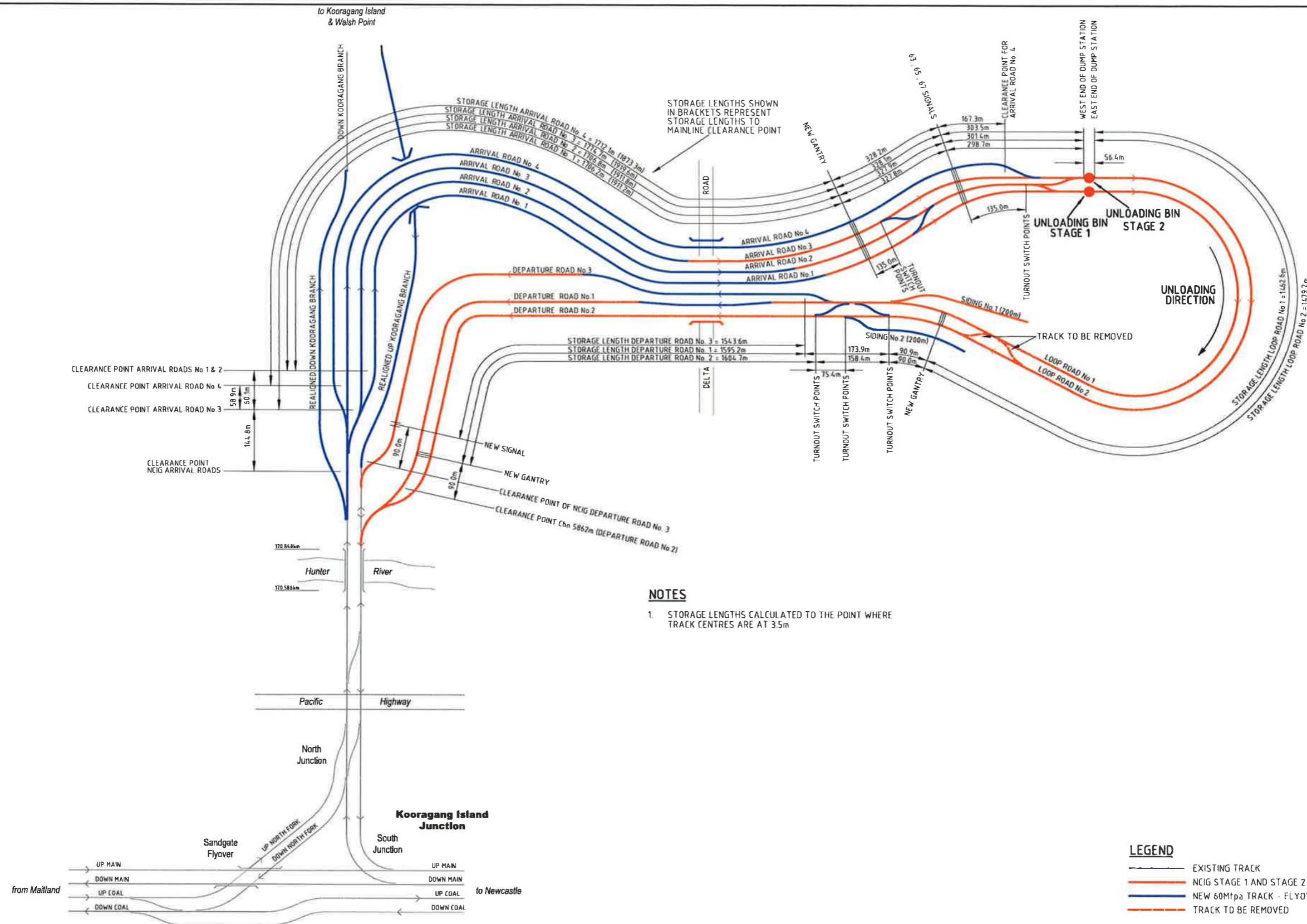

NOTES

1. STORAGE LENGTHS CALCULATED TO THE POINT WHERE TRACK CENTRES ARE AT 3.5m

LEGEND

- EXISTING TRACK
- NCIG STAGE 1 AND STAGE 2 TRACK
- NEW 60Mpa TRACK - FLYOVER OPTION
- TRACK TO BE REMOVED

Rev.	Date	Revision Details	Drn	Ver.	App.
A4	05/06/12	CLIENT AMENDMENTS		NS	
A3	28/04/12	NCIG DEPARTURE ROADS ALIGNMENT REVISED		NS	
A2	17/01/12	VERIFICATION COMPLETE		NS	
A1	06/09/11	PRELIMINARY ISSUE		NS	

aurecon HATCH

Aurecon Hatch ABN 21 646 421 651 Telephone: +61 2 9465 5599
 116 Military Road (PO Box 538) Neutral Bay Facsimile: +61 2 9465 5598
 New South Wales 2089 Australia Email: NCIGStages2F@aureconhatch.com

A person using Aurecon Hatch drawings and other data accepts the risk of:
 1. Using the drawings and other data in violation of any copyright or other laws.
 2. Using the drawings or other data for any purpose not agreed to in writing by Aurecon Hatch.

Client:

Newcastle Coal
 INFRASTRUCTURE GROUP

Drawn	Signed	Date
NS	Signed	Date
Designed	Signed	Date
NS	Signed	Date
Verified	Signed	Date
SM	Signed	Date
Approved	Signed	Date
DIB	Signed	Date

**NCIG COAL EXPORT TERMINAL - STAGE 2F
 RAIL AREA
 TRAIN STORAGE SCHEMATIC PLAN**

PRELIMINARY NOT FOR CONSTRUCTION	
Project No.	H337400
Scale	NTS
Sheet Size	A1
Drawing No.	HW03-01-R-82013
Rev.	A4